

R1/60

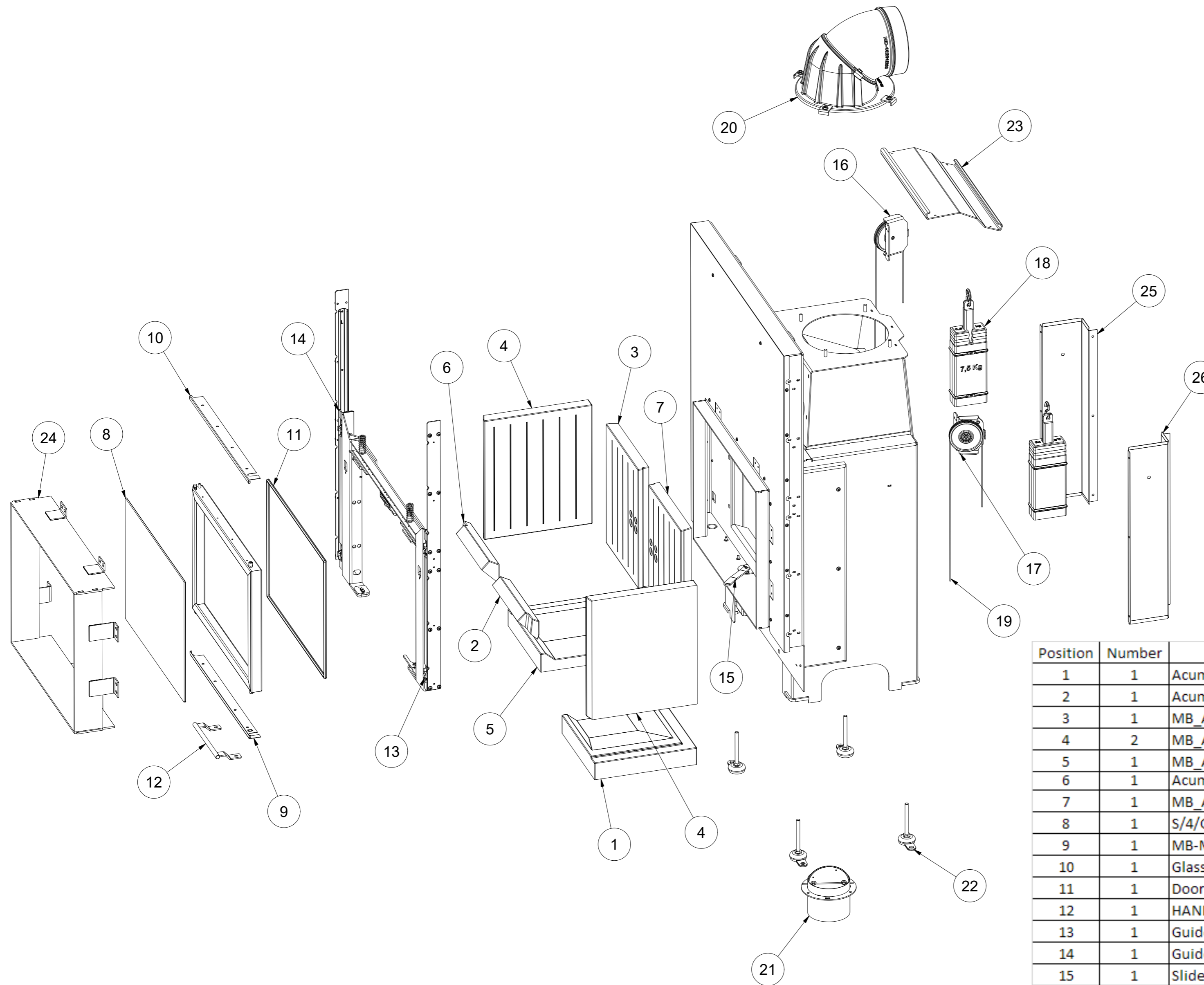

Position	Number	Name	Part No. / standard
1	1	Acumotte - base part 1	MB-M-BSL-G-11-00-00
2	1	Acumotte base ch2 - front	MB-M-14-00-00
3	1	MB_Acumotte rear panel	MB-M-BSP-G-15-00-00
4	2	MB_Acumotte panel - side	MB-M-BSP-G-17-00-00
5	1	MB_Acumotte - base part1	MB-M-BSP-G-11-00-00
6	1	Acumotte base part 1 - front	MB-M-13-00-00
7	1	MB_Acumotte rear panel - right	MB-M-BSP-G-16-00-00-00
8	1	S/4/G/558x396/MB/M/G/BEZ/LOGO	S/4/G/558x396/MB/M/G/BEZ/LOGO
9	1	MB-M-6045G_Glass pressure bar - bottom	MB-M-6045G_02-00-07
10	1	Glass pressure bar - top	MB-M-6045G_02-00-06
11	1	Door sealing cord fi 8 - 1.9 mb	MB-M-6045G_02-02-8
12	1	HANDLE/MB/ROCOSSA	HANDLE/MB/ROCOSSA
13	1	Guide unit P	MB-120-G-02-05-00
14	1	Guideway assembly L	MB-120-G-02-04-00
15	1	Slide - handle	MB-O-BSP-R-G_01-11-00
16	1	Block L	MB-M-R-G-04-01-00
17	1	Block P	MB-M-R-G-04-02-00
18	2	Weight_7.5-10kg	OG-7,5-10
19	2	Cable Weight	STRING_07-860/CUSHA
20	1	Exhaust gas outlet	ND-03-00-00
21	1	Nadia-6551 - Throttle valve above kpl	NB-C7_The throttle valve is a combinator
22	4	GN 32-Levelling feet with fixing lug rubber bla	Levelling foot GN 32-50-M10-100-A1-S (0)
23	1		Steel deflector
24	1	MB-M-R-G_Blenda	MB-M-R-G_Blenda
25	1	Shield - 2	MB-M-R-G-02-01-12-3
26	1	Shield - 3	MB-M-R-G-02-01-12-4